

Drain: RICHARD MOFFITT DRAIN **Drain #:** 229
Improvement/Arm: LEXINGTON FARMS - SECTION 4
Operator: JDH **Date:** 4-23-04
Drain Classification: Urban/Rural **Year Installed:** 1989

GIS Drain Input Checklist

- Pull Source Documents for Scanning JDH
- Digitize & Attribute Tile Drains N/A
- Digitize & Attribute Storm Drains JDH
- Digitize & Attribute SSD JDH
- Digitize & Attribute Open Ditch N/A
- Stamp Plans JDH
- Sum drain lengths & Validate JDH
- Enter Improvements into Posse JDH
- Enter Drain Age into Posse JDH
- Sum drain length for Watershed in Posse JDH
- Check Database entries for errors JDH

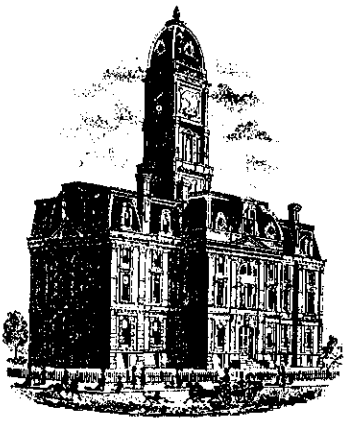

SURVEYOR'S OFFICE
Hamilton County

Kenton C. Ward, Surveyor

776-9626

942 Maple Avenue

Noblesville, Indiana 46060

October 23, 1989

TO: Hamilton County Drainage Board

RE: Richard Moffitt Drain
Lexington Farms Section 4 Arm

Attached is a petition, non-enforcement request, plans, calculations, quantity summary and assessment roll for the Lexington Farms, Section 4 Arm of the Richard Moffitt Drain.

I have reviewed the submittals and petitions and have found each to be in proper form.

I have made a personal inspection of the land described in the petition. Upon doing so, I believe that the drain is practicable; will improve the public health; benefit a public highway and be of public utility; and that the costs, damages and expenses of the proposed drain will probably be less than the benefits accruing to the owners of land likely to be benefitted. The drain will consist of the following: 6" SSD 355ft 12" RCP 495ft 18" RCP 485ft

The total length of the drain will be 1335 feet.

Only the main subsurface drains (SSD) will be maintained as part of the regulated drain. The branches for each lot will not be maintained as part of the drain. The 6" SSD at the rear of Lots 89 and 90 will not be part of the regulated drain since access to storm sewer is available. The 6" SSD in the rear of Lots 92 to 95 will be part of the regulated drain.

I have reviewed the plans and believe the drain will benefit each lot equally. Therefore, I recommend each lot be assessed equally. I recommend a maintenance assessment of \$30.00 per lot, \$5.00 per acre for roadways, with a \$30.00 minimum.

With this assessment to total annual assessment for the drain/this section will be

\$480.00.

The retention areas shown on the attached plan, (Lakes 7 and 8) will not be maintained as part of the regulated drain. These are to be maintained by the Homeowners Association with only the inlet and outlet maintained as part of the regulated drain.

A portion of the storm sewer system in this section is replacing part of the existing Richard Moffitt Drain. Station 40+40 to 45+90 will be replaced with this section. Station 45+90 to 48+00 was replaced with Section 2. These relocations were approved at hearing on July 13, 1987.

I recommend a hearing be set for December 1989. I further recommend that if approved at hearing, the Board should also approve the attached non-enforcement request.

KCW/no



Kerton C. Ward
Hamilton County Surveyor

STATE OF INDIANA)
)
COUNTY OF HAMILTON)

TO: HAMILTON COUNTY DRAINAGE BOARD
% Hamilton County Surveyor, Courthouse, Noblesville, IN 46060

In the matter of Lexington Farms Subdivision,
Section Four Drain Petition.

Petitioner is the owner of all lots in the land affected by the proposed new regulated drain. The drainage will affect various lots in Lexington Farms, a subdivision in Hamilton County, Indiana. The general route of such drainage shall be in existing easements and along public roads as shown in the plans on file in the Surveyor's Office.

Petitioner believes that the cost, damages and expenses of the proposed improvement will be less than the benefits which will result to the owners of the land likely to be benefited thereby. Petitioner believes the proposed improvements will:

- (a) improve public health
- (b) benefit a public street
- (c) be of public utility

Petitioner agrees to pay the cost of construction of the drainage system and requests periodic maintenance assessments by the Board thereafter.

The Petitioner also agrees to the following:

1. To provide the Drainage Board a Performance Bond for the portion of the drainage system which will be made a regulated drain. The bond will be in the amount of 100% of the Engineers estimate. The bond will be in effect until construction of 100% of the system is completed and so certified by the Engineer.
2. The Petitioner shall retain an Engineer throughout the construction phase. At completion of the project the Petitioner's Engineer shall certify that the drainage system which is to be maintained as a regulated drain has been constructed as per construction plans.

FILED
FEB 16 1989
 HAMILTON COUNTY DRAINAGE BOARD
 SECRETARY

3. The Petitioner agrees to request in writing to the County Surveyor any changes from the approved plan and must receive written authorization from the County Surveyor prior to implementation of the change. All changes shall be documented and given to the Surveyor to be placed in the Drain File.

4. The Petitioner shall instruct his Engineer to provide a reproducible print on a 24" x 36" mylar of the final design of the Drainage System. This shall be submitted to the County Surveyor prior to the release of the Performance Bond.

5. The Petitioner shall comply with the Erosion Control Plan as as specified on the construction plans. Failure to comply with the Erosion Control Plan shall be determined by the Board as being an obstruction to the drainage system. The County Surveyor shall immediately install or repair the needed measures at Petitioners cost as per IC 36-9-27-46.

The Petitioner further requests that the Drain be classified as an Urban Drain.



 Signed

 Dean S. Ziegler, President
 Printed Name
 Davis Development - Lexington Farms, Inc.
 an Indiana Corporation General Partner of

 Lexington Farms Associates, an Indiana

 Signed Limited Partnership

 Printed Name

RECORDED OWNER(S) OF LAND INVOLVED

DATE _____

BANK ONE

BANK ONE, INDIANAPOLIS, NA
Indianapolis, Indiana 46277

September 29, 1989

Irrevocable Credit No. S-3568-G
Hamilton County Commissioners
Courthouse
Noblesville, Indiana 46060

Gentlemen:

We hereby authorize you to value on us for the account of
Davis Financial Investments, Ltd.,
an Indiana Limited Partnership
8200 Haverstick Road Suite 250
Indianapolis, Indiana 46240

For a sum or sums in U.S. Dollars not exceeding a total of: Thirty Eight
Thousand Seven Hundred Ninety Six and 00/100.
*****\$38,796.00

Available by drafts at sight drawn on Bank One, Indianapolis, NA, Indianapolis,
Indiana.

PURPOSE: Section #4 Storm Sewers, Lexington Farms.

Drafts must be presented to the drawee not later than September 30, 1991 at our
counters.

All drafts must be marked, "Drawn under Bank One, Indianapolis, NA,
Indianapolis, IN Credit No.S-3568-G".

We hereby agree with you that drafts drawn under and in compliance with the
terms of this credit shall be duly honored on due presentation to the drawee.

This credit is subject to Uniform Customs and Practice for Documentary Credits
(1983 Revision) ICC Publication No. 400.

Bank One, Indianapolis, NA

Authorized Signature

8923406

September 29, 1989

Irrevocable Credit No. S-3568-G
Hamilton County Commissioners
Courthouse
Noblesville, Indiana 46060

This Instrument Recorded 10-18 1989
Sharon K. Cherry, Recorder, Hamilton County, IN

RECEIVED
FOR RECORDS
OCT 10 1 44 PM '89
SHARON K. CHERRY
RECORDER
HAMILTON CO., IN

Gentlemen:

We hereby authorize you to value on us for the account of
Davis Financial Investments, Ltd.,
an Indiana Limited Partnership
8200 Haverstick Road Suite 250
Indianapolis, Indiana 46240

For a sum or sums in U.S. Dollars not exceeding a total of: Thirty Eight
Thousand Seven Hundred Ninety Six and 00/100.
*****\$38,796.00

Available by drafts at sight drawn on Bank One, Indianapolis, NA, Indianapolis,
Indiana.

PURPOSE: ~~For the purpose of financing the purchase of real estate~~

Drafts must be presented to the drawee not later than September 30, 1991 at our
counters.

All drafts must be marked, "Drawn under Bank One, Indianapolis, NA,
Indianapolis, IN Credit No.S-3568-G".



We hereby agree with you that drafts drawn under and in compliance with the
terms of this credit shall be duly honored on due presentation to the drawee.

This credit is subject to Uniform Customs and Practice for Documentary Credits
(1983 Revision) ICC Publication No. 400.

Bank One, Indianapolis, NA

BOARD OF COMMISSIONERS
OF THE COUNTY OF HAMILTON

Authorized Signature

DATE 10/16/89

ATTEST: 
HAMILTON COUNTY AUDITOR



SURVEYOR'S OFFICE
Hamilton County

Kenton C. Ward, Surveyor

Suite 146

776-8495

One Hamilton County Square

Noblesville, Indiana 46060-2230

July 8, 1994

TO: Hamilton County Drainage Board

RE: Richard Moffitt Drain- Lexington Farms-Section 4 Arm

Attached are as-builts, and other information for the Lexington Farms-Section 4 Arm. An inspection of the drainage facilities for this section has been made and the facilities were found to be complete and acceptable.

During construction of the drain there were not any significant changes made to the plans submitted with my report dated October 23, 1989. Therefore, the length of the drain remains at 1335 feet.

The bond or letter of credit from Bank One, number S-3568-6, dated September 29, 1989, in the amount of \$38,796.00, has been released.

I recommend the Board approve the drains construction as complete and acceptable.

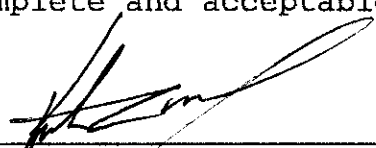

Kenton C. Ward
Hamilton County Surveyor
KCW/no

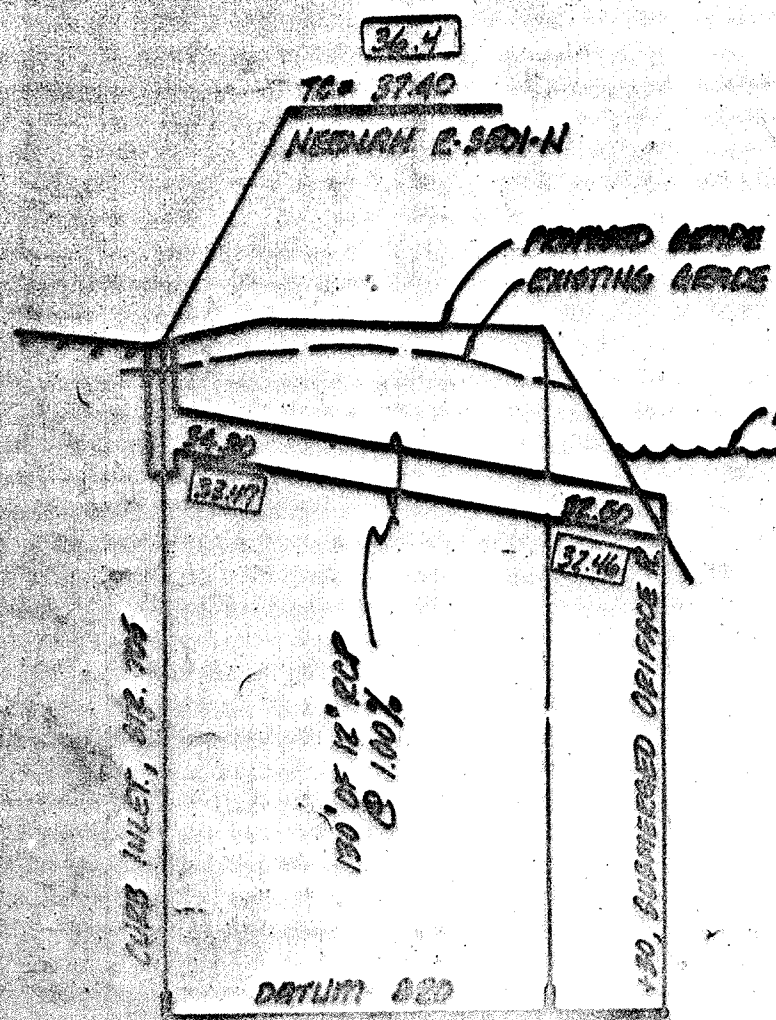

PROFILE ONE
 H: 1" = 10'
 V: 1" = 5'
RECORD DRAWING

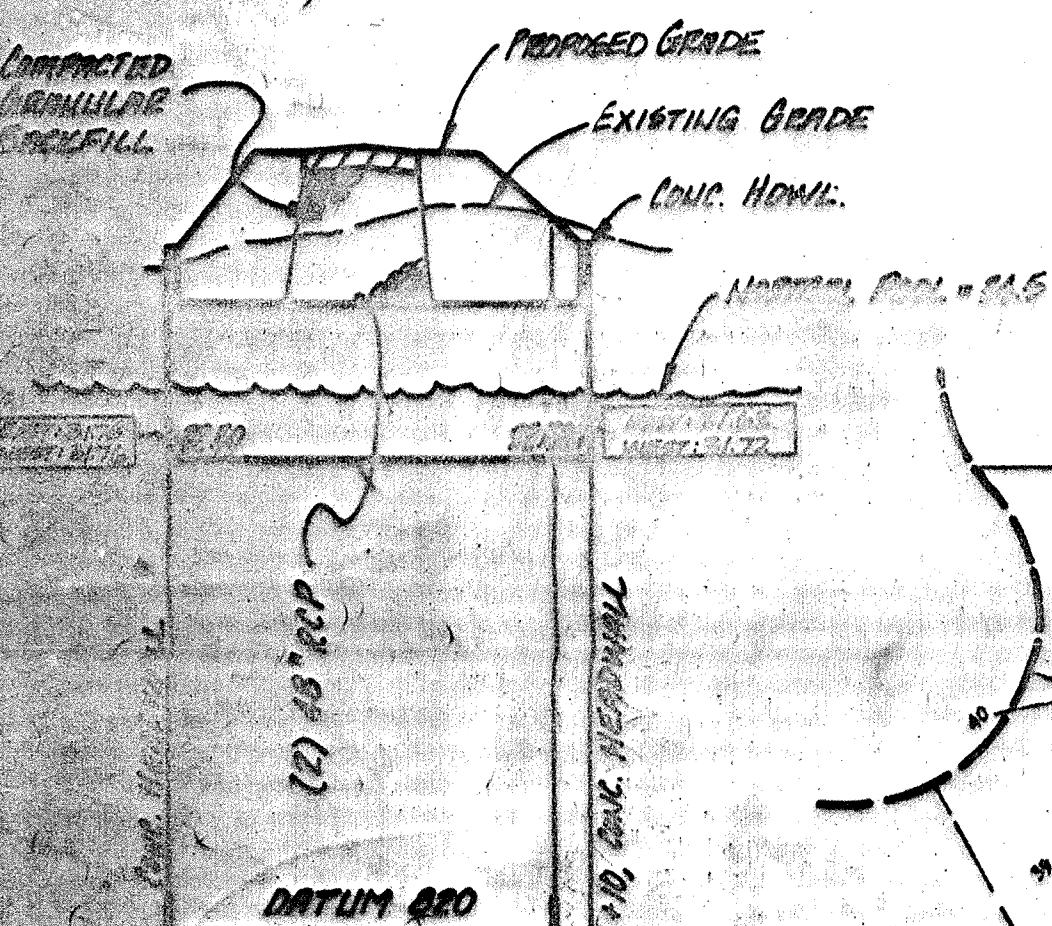

PROFILE TWO
 H: 1" = 10'
 V: 1" = 5'

NOTE: ACCESS ROAD FOR PUBLIC SERVICE INDIANA TO BE PROVIDED FROM LATONIA LANE TO 111ST STREET (SEE SHT. 10)

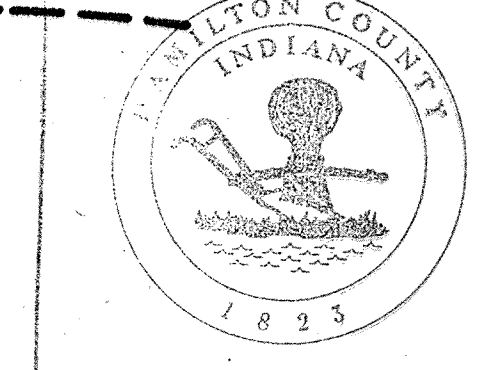
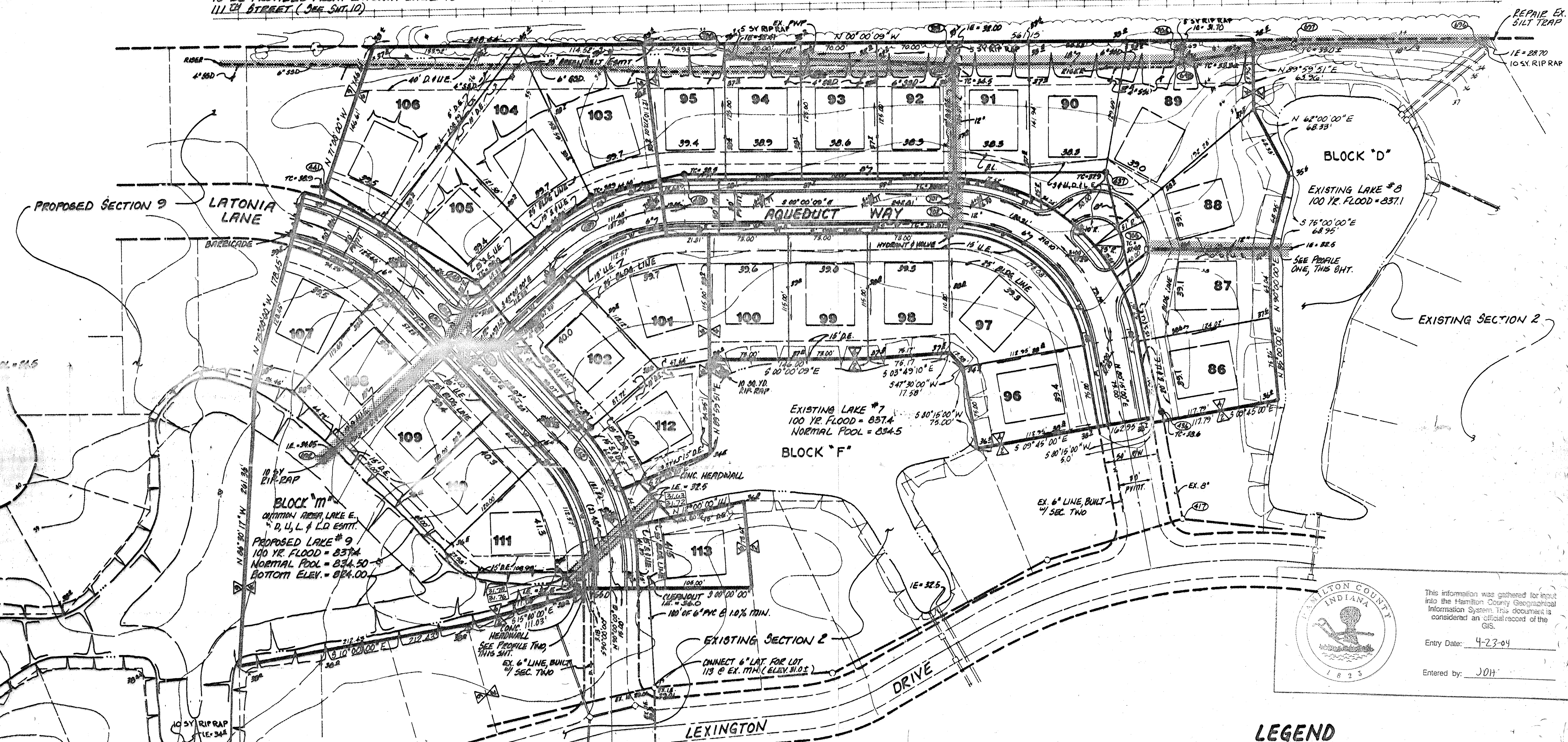

This information was gathered for input into the Hamilton County Geographical Information System. This document is considered an official record of the GIS.
 Entry Date: 4-23-04
 Entered by: J0H

LEGEND

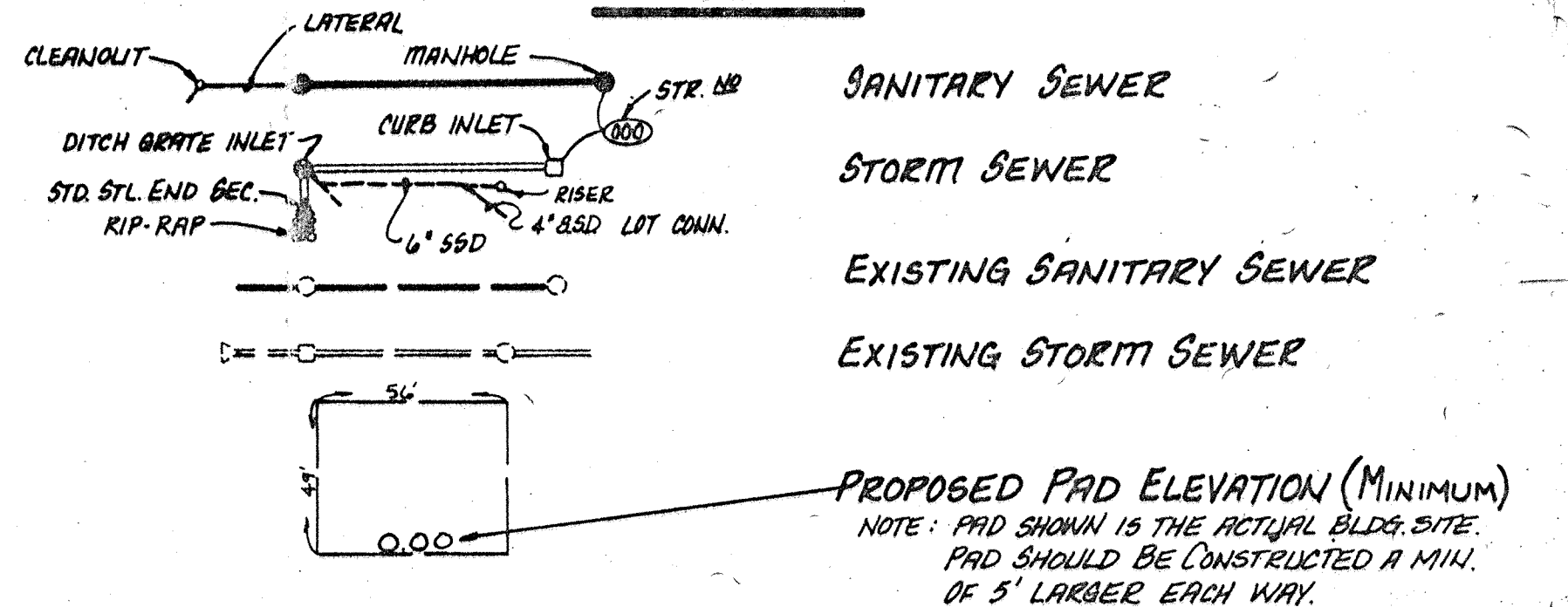

NOTES:

1. BEARINGS, DIMENSIONS, AND EASEMENTS ARE SHOWN FOR REFERENCE ONLY AND DO NOT NECESSARILY DEPICT ACTUAL RECORDED INFORMATION. SEE RECORDED PLAT FOR EXACT INFORMATION.
2. UNLESS A NATURAL OUTLET EXISTS, EACH LOT IS TO BE PROVIDED A 4" S&D LATERAL FOR FOUNDATION DRAINS ONLY. GUTTERS OR OTHER DRAINAGE STRUCTURES ARE NOT TO BE CONNECTED TO THE S&D SYSTEM.
 UNLESS NOTED ON PLAN, S&D IS TO BE:
 - 6" PERFORATED PVC MAIN LINE SERVING 2 OR MORE LOTS OR ALONG SHALE OR CUTS
 - 4" NON PERFORATED PVC LATERAL TO EACH LOT
3. ELEVATIONS SHOWN AT CENTERLINE OF STREET ARE TOP OF CURB ELEVATIONS AT THAT RESPECTIVE STATION.
4. WATER MAINS ARE SHOWN FOR REFERENCE ONLY. TO BE DESIGNED AND INSTALLED BY INDIANAPOLIS WATER CO.
5. NO WATER SHALL BE PERMITTED TO FLOW INTO THE SANITARY SEWER PIPE WHILE UNDER CONSTRUCTION.

TYPICAL DETENTION LAKE SECTION

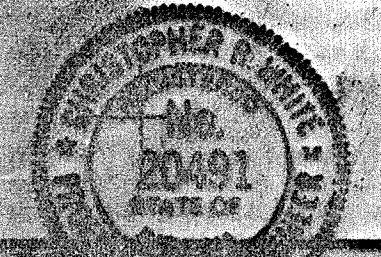
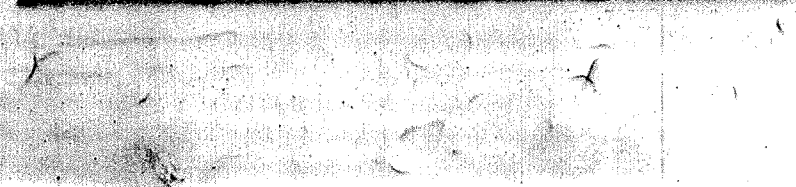

11-17-99 DATE

REVISIONS	
11-17-99 ADD 820, EXISTING, WATER MAIN	RJS
12-9-99 ADD 820, EXISTING, WATER MAIN	RJS
12-9-99 ADD 820, EXISTING, WATER MAIN	RJS
12-9-99 ADD 820, EXISTING, WATER MAIN	RJS

PAUL I. CRIFE, INC.
 7172 GRAHAM ROAD
 INDIANAPOLIS, INDIANA 46250
 (317) 842-6777

• CIVIL ENGINEERING
 • LAND SURVEYING
 • ARCHITECTURE
 • LAND PLANNING

TECH. CHK.	CHK.	DRAWN BY	SCALE	DATE	CLIENT
		GSD	1" = 50'	11-17-99	LEXINGTON FARMIS - SEC. 4 & 6
DFTNG. CHK.		DRAWING TITLE			
		SITE DEVELOPMENT PLAN			

DWG. TYPE	FILE NUMBER	SHEET
		2
JOB NUMBER		OF 10
87339-40000		